

PROPOSED CONSTRUCTION OF G+VII RESIDENTIAL CUM COMMERCIAL BUILDING BLOCK-I & G+V RESIDENTIAL BUILDING BLOCK-II OF TARUN KUMAR KUNDU, SUMITA KUNDU, ARIJIT KUNDU ON C.S. DAG NO.-244(PART), L.R. DAG NO.- 1571, C.S. KHATIAN NO.-212, L.R. KHATIAN NO.- 6711,6712 & 6713, MOUZA-KENDUADIHI, J.L. NO.-213, WARD NO.- 22, UNDER P.S & DIST. & MUNICIPALITY - BANKURA.

SPECIFICATIONS:-

1. DEPTH OF FOUNDATION IS AT 1.50 M BELOW EX. G.L.
2. SAFE BEARING CAPACITY OF SOIL IS AS PER SOIL TEST REPORT.
3. GRADE OF CONC. IS M-20 AND GRADE OF STEEL IS Fe-500
4. CLEAR COVER TO MAIN REIN. IS AS PER BELOW :-
a). FOUNDATION - 40 MM. b) COLUMN - 40 MM.
c). BEAM - 25 MM. d). SLAB - 15 MM.
5. ALL SLABS MUST BE CAST MONOLITHIC WITH SUPPORTING BEAM.
6. ALL OTHER SPECIFICATIONS ARE AS PER NATIONAL BUILDING CODE OF INDIA.

THE STRUCTURAL DESIGN & DRAWING OF BOTH FOUNDATION AND SUPERSTRUCTURE OF THE BUILDING HAS BEEN MADE BY ME CONSIDERING ALL POSSIBLE LOADS INCLUDING THE SEISMIC LOAD AS PER N.B.C. OF INDIA & CERTIFIED THAT IT IS SAFE & STABLE IN ALL RESPECT.

Signature
CHIEF ENGINEER
 DISTRICT MUNICIPALITY
 BANKURA

SIG. OF STRUCTURAL ENGINEER

Signature
Subodh Chandra Pal
 Enlisted Planner
 Under Bankura Municipality
 Licence No. 193/2019

Signature
SURAJ KARMAKAR
 REG. NO. 8161/2019 (D.C.E.)
 Enlisted Building Planner & Estimator
 Enlisted Under Bankura Municipality
 District, Bankura.

SIG. OF L.B.S.

Signature
Ranjit Bhattacharya
 REG. NO. CA/87/10587

SIGNATURE OF ARCHITECT

RAGHUNATHJEE CONSTRUCTION
Signature
 Proprietor

SIGNATURE OF DEVELOPER

RAGHUNATHJEE CONSTRUCTION
Signature
 Proprietor

Constitute attorney of
 Tarun Kumar Kundu,
 Sumita Kundu,
 Arijit Kundu.

SIGNATURE OF OWNER

BHATTACHARYA & ASSOCIATES.
 ARCHITECTS, ENGINEERS & INT. DESIGNERS
 10/8B, DIAMOND HARBOUR ROAD
 KOLKATA-700028
 Tel : 98301 33344-8821
 e-mail: archrajy@gmail.com

DRAWN BY :- S.J. DATE :- 13.05.19

SHEET No. :- 5/1

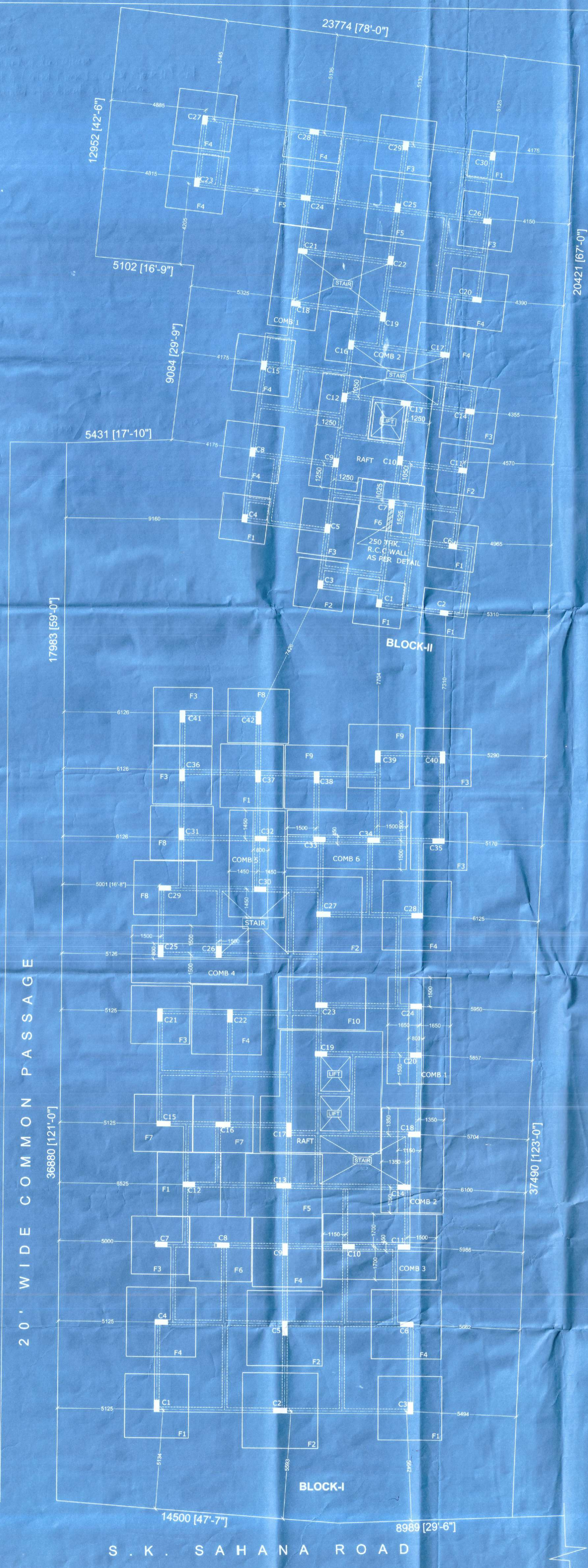

FOUNDATION LAYOUT PLAN
 SCALE - 1:100